

Lower Level

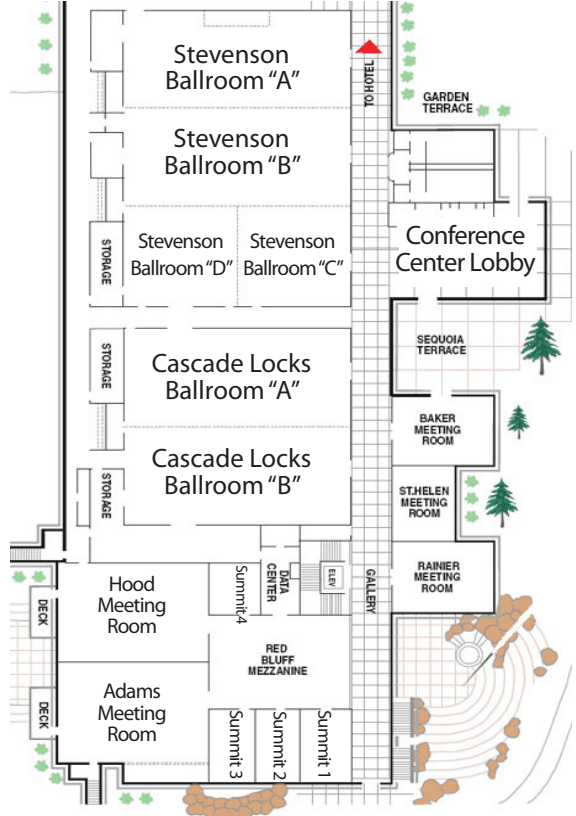

Upper Level



NORFMA

Northwest Regional Floodplain Management Association

Conference Sponsors

Platinum Sponsors



Gold Sponsors



Silver Sponsors

ESA Adolfson
DHI Solutions
OTAK



www.norfma.org



September 8-10, 2010
Skamania Lodge, Stevenson, WA

Conference Committee

Jerry Louthain, HDR (Chair)

Hans Hunger, *Pierce County*

Dianna Woods, Yakima County

Dan Sokol, *Dept. of Ecology*

Henry Hu, *West Consultants*

Vaughn Collins, NHC

Monica Mannerstrom, NHC

Paula Cooper, Whatcom County

Alan Wald, Applied Hydrology NW

Mary Ann Reinhart, GeoEngineers

Mary McGown, Idaho Dept of Water Resources

Greg Laird, Otak

NORFMA BOARD

Chair

Henry Hu
WEST Consultants, Inc.

Vice Chair

Dianna Woods
Yakima County Surface Water

Treasurer

Paula Cooper
Whatcom County River & Flood

Secretary

Alan Wald
Applied Hydrology Northwest

Regional Representatives

Alaska

Taunnie Boothby, *State Flood Insurance Program Coordinator*

British Columbia

Monica Mannerstrom, NHC

Idaho

Mary McGown, *Dept. of Water Resources*

Oregon

Christine Shirley

Washington

Dan Sokol, *Dept. of Ecology*



NORFMA ANNUAL CONFERENCE

September 8-10, 2010

Skamania Lodge, Stevenson, WA

Welcome to the 2010 Annual Conference of the Northwest Regional Floodplain Management Association (NORFMA)!

NORFMA is a nonprofit organization for regional networking on floodplain management issues, including watershed-based environmental quality, economic sustainability, and scientific discovery. NORFMA provides a forum for regional communication and cooperation in Oregon, Washington, Idaho, British Columbia, and Alaska.

This year's conference is being held in Stevenson, WA. The conference agenda includes presentations, workshops, and a field trip. Also note that the NORFMA Board will be holding a meeting and annual Board member elections during the conference. Thank you for joining us, and enjoy the conference.

CONFERENCE SCHEDULE

Tuesday, September 7, 2010

7:00pm - 10:00pm

Informal social get together for those arriving the night before.
Hood River Suite

Wednesday, September 8, 2010

7:00am - 5:00pm

Registration Desk Open - Conference Center Lobby

7:00am - 8:00am : Continental Breakfast - Cascade Locks Ballroom

8:00am - 10:00am

Cascade Locks Ballroom - Moderated by Henry Hu, NORFMA Chair

RFC Operations and Flood Season Forecast

(Steve King, NW River Forecast Center)

FEMA Region X Update - BiOP issues for both Washington & Oregon, Risk Map Updates

(Nick Delmedico, Brett Holt, Mark Eberlein, Karen Wood-McGuinness)

10:00am - 10:30am

BREAK TIME - View Exhibits & Posters

10:30am - 12:00pm

Cascade Locks Ballroom - Moderated by Jerry Louthain P.E., HDR - Conference Chair

State Coordinators Update / Panel Discussion Q&A

(Dan Sokol (WA), Mary McGown (ID), Christine Shirley (OR), Taunnie Boothby (AK))

Beyond the Puget Sound BiOP: Fixing Floodplain Management Problems

(Dan Siemann, National Wildlife Federation)

12:00pm - 1:30pm

Introduction: Hans Hunger P.E., Pierce County

LUNCHEON - Keynote: Bob Sallinger, Portland Audubon

1:30pm - 3:00pm

Cascade Locks A - Mod: Jerry Louthain
Pending Changes to the 2012 CRS Manual
(French Wetmore, French & Associates)

3:00pm - 3:30pm

BREAK TIME - View Exhibits & Posters

3:30pm - 5:00pm

Cascade Locks A - Mod: Mary McGown
Idaho DWR-IDWR ArcGIS Mapping Application
(Barbara McEvoy & Zach Mailard, Idaho DWR)

Responding to Unacceptable Levee Ratings - The Dallas Experience

(Rob Vining, HNTB)

RiverRAT, Web-based River Restoration Analysis Tool

(Janine Castro, USFWS)

5:15pm - 6:30pm

Social Networking Event - Stevenson A

6:30pm - 7:30pm

DINNER ON YOUR OWN

7:30pm - 9:00pm

Evening Discussion - Stevenson A

Nile Landslide Event in Yakima County

Informal discussion by Joel Freudental, Yakima County

Tour of Bonneville Dam

Field Trip, Friday September 9, 2010

This will be a self guided tour. Coordinated by Dan Sokol, Washington State Floodplain Coordinator.



Thursday, September 9, 2010

7:00am - 5:00pm

Registration Desk Open - Conference Center Lobby

7:00am - 8:00am

Individual State Breakout Sessions - Summit 1 (ID) & 2 (AK), Stevenson C (WA) & D (OR)

Continental Breakfast - Lobby

8:00am - 10:00am

Cascade Locks A - Mod: Hans Hunger
Elevation Certificates: Avoiding Errors & Expensive Flood Insurance
(Dennis Dixon, Pierce County)

Elwha Dam Removal

(Travis Ball, USACE)

Incorporating hardened vegetated buffers along Puyallup River, WA levees

(Tim Abbe, ENTRIX)

10:00am - 10:30am

BREAK TIME - View Exhibits & Posters

10:30am - 12:00pm

Cascade Locks A - Mod: Jerry Louthain
Chehalis River Flood Authority Update- People, Politics, and Projects
(Bruce Mackey, ESA Adolfson)

Preparing for Trouble: Flood Warning Systems in Washington State

(Emily Y. Spahn, WEST Consultants, Inc.)

12:00pm - 1:30pm

LUNCHEON - NORFMA Meeting, Elections, ASFPM Foundation Briefing
(Raffle Drawing)

1:30pm - 3:00pm

Cascade Locks A
The Green River: Being Forced to look at Risk Differently
(Bob Freitag, UW)

Web Soil Survey

(Brad Duncan, NRCS Washington State)

3:00pm - 3:30pm

BREAK TIME - View Exhibits & Posters

3:30pm - 5:00pm

Cascade Locks A - Mod: Dan Sokol
Statewide Levee Inventory
(Jonah Stinson, Western WA U)

5:00pm

DINNER ON YOUR OWN

Friday, September 9, 2010

8:00am - 9:00am : Coffee & Tea - Conference Center Lobby

8:00am - 12:00pm

CFM EXAM - Rainier Room (Proctored by Mary G. McGown, PH.D., CFM)

8:00am - 12:00pm

Field Trip - Tour of Bonneville Dam (Dan Sokol, Washington State Floodplain Coordinator)

8:00am - 12:00pm

Workshop (Stevenson C)
Climate Change & Adaptation
(Bob Freitag, UW)

Workshop (Stevenson D)
Mapping with HEC-GeoRAS
(Yalcin & Bengtson, WEST Consultants)

Workshop (Jefferson)
Floodproofing
(Wallace A. Wilson, PE, CFM, W A Wilson Consulting)